

# Montaža jarbola

## Pojedinosti na jarbolu



## Distributer

## Način montiranja opreme na jarbol

VANJSKI KONOP    UNUTARNJI KONOP

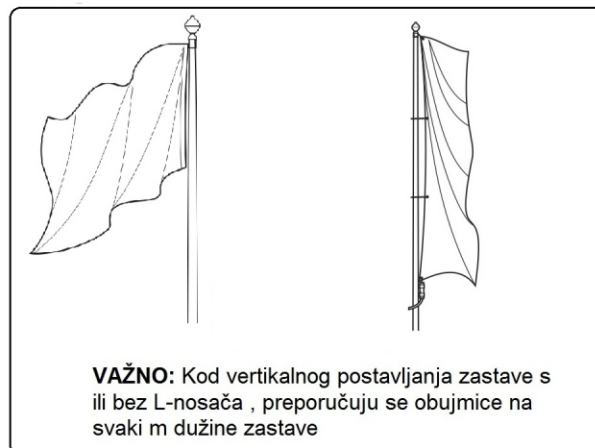
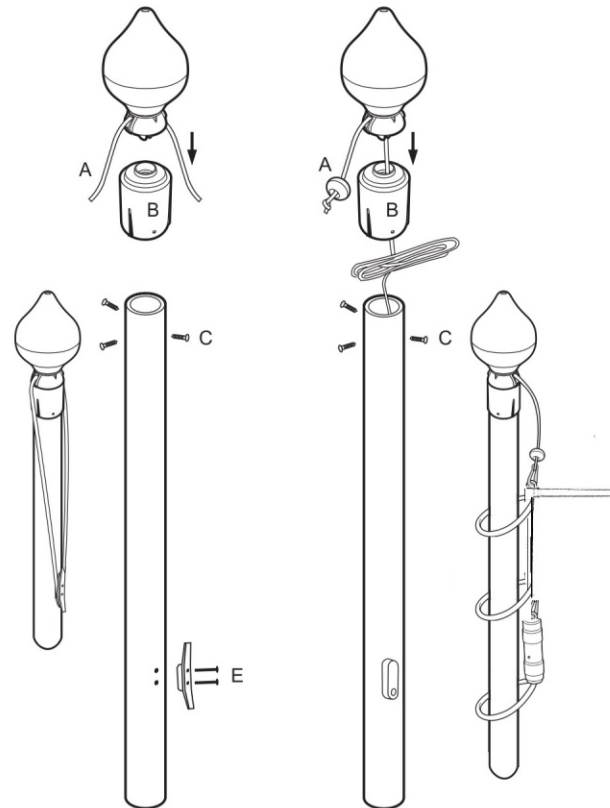

## Montaža jarbola na postolje

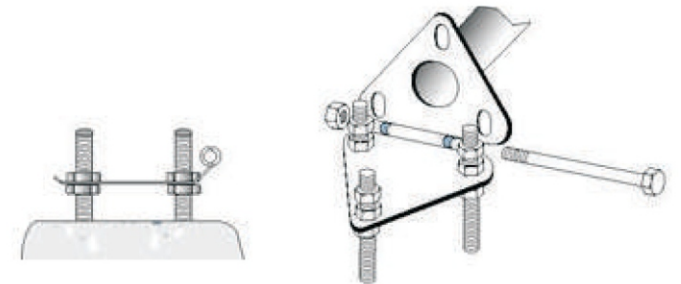

- Navrnuti velike matice na ankere 10 mm do polu matice
- Montirati vijak s maticom u baglamu
- Uspraviti jarbola
- Navrnuti velike matice da drže jarbol uspravno

Jarbol nivelirati koristeći vaservagu

- Po potrebi, jarbol nivelirati dotezanjem ili odvrtnjem matica
- Nakon 4-6 tjedana obavezno kontrolirati i dotegnuti matice

